



# ASPIRE

— TO MOVE —



## Jellicoe Avenue, Stapleton, Bristol, BS16

Jellicoe Avenue is located in Stoke Gifford and next to the University of West of England. It is 1.4 miles from a large superstore in Filton, as well as 1.6 miles from Filton Abbey Wood Train Station. There are a few smaller stores, as well as pubs and restaurants in the local residential areas as well.

- Three bedrooms
- Students or sharers
- Flexible availability
- Council tax band C
- Holding deposit - £484.00
- Furnished
- Apartment

**£2,100 Per month**

# Floor Plans

## SECOND FLOOR 625 sq.ft. (58.1 sq.m.) approx.

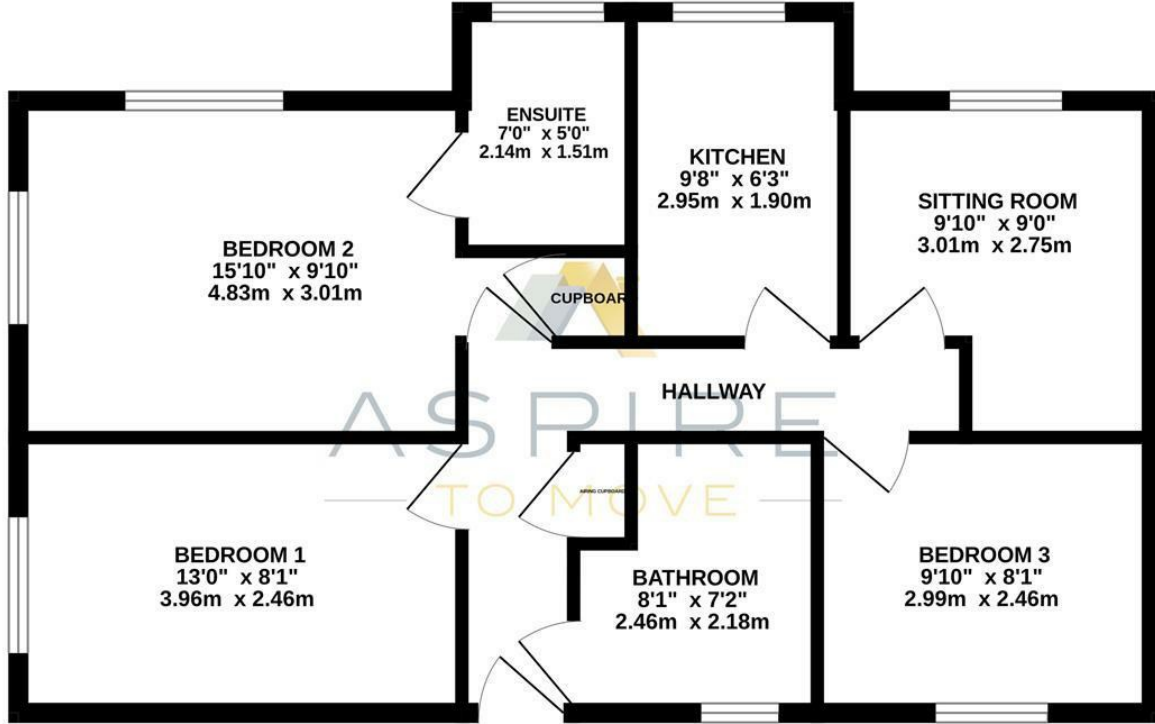

TOTAL FLOOR AREA : 625 sq.ft. (58.1 sq.m.) approx.

Whilst every attempt has been made to ensure the accuracy of the floorplan contained here, measurements of doors, windows, rooms and any other items are approximate and no responsibility is taken for any error, omission or mis-statement. This plan is for illustrative purposes only and should be used as such by any prospective purchaser. The services, systems and appliances shown have not been tested and no guarantee as to their operability or efficiency can be given.  
Made with Metropix ©2023

## Energy Performance Graph

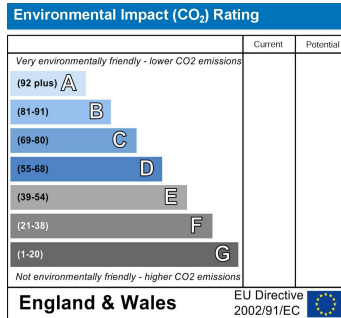
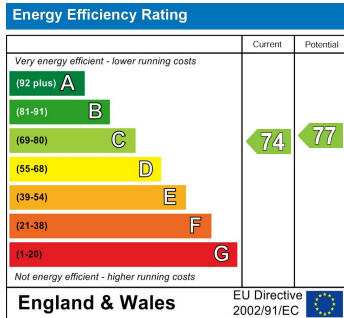

These particulars, whilst believed to be accurate are set out as a general outline only for guidance and do not constitute any part of an offer or contract. Intending purchasers should not rely on them as statements of representation of fact, but must satisfy themselves by inspection or otherwise as to their accuracy. No person in this firm's employment has the authority to make or give any representation or warranty in respect of the property.